

STANDARD OCTAGON

Span 12 m, ht 2.50m and 3m

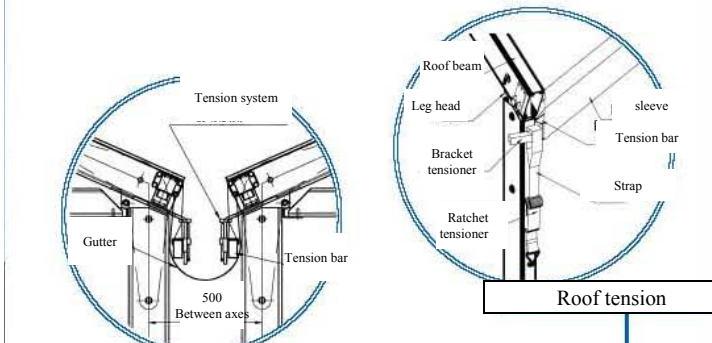

Juxtaposed structures

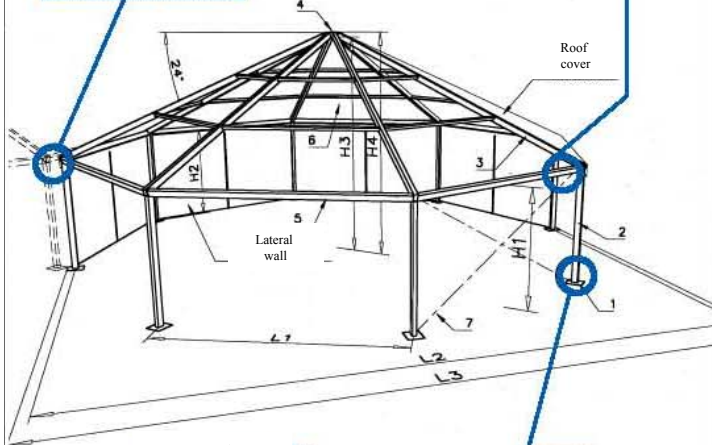

Specifications		12 m	
		ht 2,50 m	ht 3 m
Span	L2	12	12
Overall Width	L3	12,35	12,35
External lateral height		2,44	2,99
Internal lateral height	H2	2,35	2,9
External ridge height	H4	5,12	5,67
Internal ridge height	H3	4,95	5,5
Under eaves height	H1	2,35	2,9
Bay	L1	4,59	4,59
Area		102 m ²	102 m ²
Roof pitch		24 °	24°
Base plate	1	350x300	350x300
Leg	2	177x75	177x75
Roof beam	3	177x75	177x75
Apex joint	4		
Eaves purlin	5	125x75	125x75
Intermediate purlin	6	60x60	60x60
Number of intermediate purlins		16	16
Lateral bracing cable	7	diam. 8 mm	diam. 8 mm

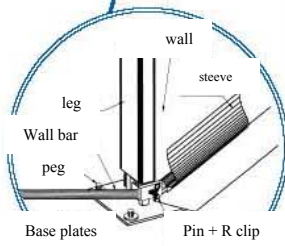
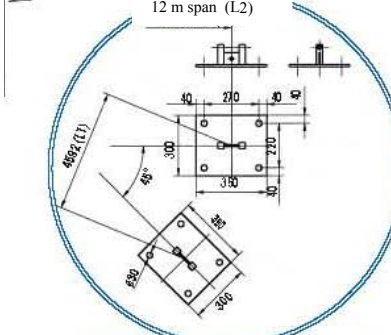

Wall tension

Erection/dismantling	12m Octagon
Number of people	4
Total duration of erection	7 hours
vehicles + duration	12 m fork lift truck - 4 hours
Necessary equipment provided with frame	1 toasting fork 2,20 m and 3,80 m + 2 no. toasting bars 6m ; 2 ropes 20 m Ø 12 mm ; 2 handles for ratchet tensioner
Necessary equipment not provided	2 no. 4m ladders, 1 no.20 m measuring tape sledgehammers, hammers, adjustable spanners
Time saved for dismantling	30%

* exemples details and explanations page 112

Base plates

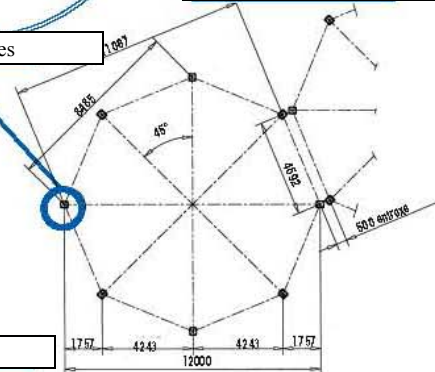

Setting out

Anchoring and weighting	Anchoring			Weighting	
	Uplift force kg	Coef.	Number of pegs	Uplift force kg	Coef.
Common + intermediate braced base plate	870	2	2 lg 850	720	1,65

* exemples details and explanations page 112

Load Bearing	Height 2,50 and 3 m
With snow	F = 0 kg
Without snow	F = 100 kg

* exemples details and explanations page 112

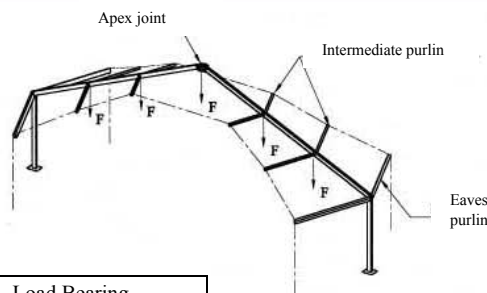

Load Bearing

Packaging	Frame	Covers	Example* octagon 12x3
	12m	12m	
Weight w without packaging (kg)	1136	214	1362
Weight w without packaging CV/bay	12		
Number of cover racks			1
Number of frame racks			1
Number of boxes/crates			1
Theoretical surface required for transport by lorry on rack			7x1,2 m
Theoretical surface required for transport by lorry in bundles			7x1,2m
Theoretical number of structures per container (in bundles) 20' dry			6
Theoretical number of structures per container (in bundles) 40' open-top			
Longest piece : roof beam 6542 m			
Description of packaging, Covers in bags, on pallet or on rack Frame in bundles, loose or rack			

* Calculated on basis of complete structures, not mixed